Fencing Gates (A&A Lamb)

Contents

A&A Lamb

Aby Richards
aby@lambfencing.co.uk
Walton New Road
Upper Bruntingthorpe
Nr. Lutterworth
Leicestershire
LE17 5RD
01162 478396



winvic

winvic.co.uk

Contents

Scope of Works

Certificates/Warranties/Guarantees

Cleaning and Maintenance Regimes

Data Sheets



winvic

winvic.co.uk

Scope of Works



winvic

winvic.co.uk

A. & A. LAMB LIMITED

FENCING CONTRACTORS

Walton New Road ° Upper Bruntingthorpe ° Nr Lutterworth ° Leics. LE17 5RD

Telephone: 0116 247 8396 ° Fax No: 0116 247 8876

Zoe Stanton
Winvic Construction Ltd
Brampton House
19 Tenter Road
Moulton Park
Northampton
NN3 6PZ

3rd August 2022

Dear Sirs

RE: Winvic Construction Ltd – P21-024, Calder Park, Wakefield

Please find below the information you require.

Our company has supplied various types of fencing on the above contract. We give below details of the materials and suppliers we have used:

- 1) 760mm high armco with posts at 3.2m centres, galvanized finish.**

Supplier

IAE Fencing Ltd
Mossfield Road
Adderley Green
Stoke on Trent
Staffordshire
ST3 5BW
Tel: 01782 339320
Fax: 01782 339321

- 2) 2.4m high v-mex mesh fence and gates, ppc finish RAL 9005 Black.**

Supplier

IAE Fencing Ltd
Mossfield Road
Adderley Green
Stoke on Trent
Staffordshire
ST3 5BW
Tel: 01782 339320
Fax: 01782 339321

A. & A. LAMB LIMITED

FENCING CONTRACTORS

Walton New Road ° Upper Bruntingthorpe ° Nr Lutterworth ° Leics. LE17 5RD

Telephone: 0116 247 8396 ° Fax No: 0116 247 8876

- 3) GA3250 automated barriers and GA6000 automated gates.**

Supplier

Gateway Automation Ltd
Unit 8
Wainer Close
Lincoln
LN6 3RY
Tel: 01522 682255

- 4) 4.1m long circonomy cycles to suit 10no cycles, ppc finish RAL 9005 Black.**

Supplier

IAE Fencing Ltd
Mossfield Road
Adderley Green
Stoke on Trent
Staffordshire
ST3 5BW
Tel: 01782 339320
Fax: 01782 339321

- 5) Level Access bollards, ppc finish RAL 9005 Black and RAL 1021 Yellow.**

Supplier

IAE Fencing Ltd
Mossfield Road
Adderley Green
Stoke on Trent
Staffordshire
ST3 5BW
Tel: 01782 339320
Fax: 01782 339321

A. & A. LAMB LIMITED

FENCING CONTRACTORS

Walton New Road ° Upper Bruntingthorpe ° Nr Lutterworth ° Leics. LE17 5RD

Telephone: 0116 247 8396 ° Fax No: 0116 247 8876

- 6) 1.5m high x 114mm diameter stainless steel bollards.

Supplier

IAE Fencing Ltd
Mossfield Road
Adderley Green
Stoke on Trent
Staffordshire
ST3 5BW
Tel: 01782 339320
Fax: 01782 339321

- 7) 1.8m high double sided timber hit and miss fencing and gates, tanalith E treated timber.

Supplier

Harlow Bros Ltd
Long Whatton
Loughborough
Leicestershire
LE12 5DE
Tel: 01509 842561
Fax: 01509 843577

Fence

Gates

G & B Woodworking
Unit 1, Meadow Springs Farm
Saddington Road,
Shearsby
Leicester
LE17 6PX
Tel: 01162478779

- 8) Timber post and 3 rail fence, tanalith E treated timber.

Supplier

Charles Ransford & Son Ltd
Station Street
Bishops Castle
Shropshire
SY9 5AQ
Tel: 01588 638331
Fax: 01588 630491

Fence

Certificates/Warranties/Guarantees



winvic

winvic.co.uk



CERTIFICATE

CERTIFICATION CODE: CU-COC-849560

Field of attention:
FSC Chain of Custody (COC)

Issued to:
Harlow Bros Limited
Loughborough, UNITED KINGDOM
Project in: **UNITED KINGDOM**

Standard:

FSC-STD-50-001 (V1-2) Requirements for use of the FSC trademarks by Certificate Holders
FSC-STD-40-004 V2-1 FSC Standard for Chain of Custody Certification
FSC-STD-40-003 V2-1 CoC Certification of Multiple Sites

Valid until: 13 May 2022

The validity of this certificate shall be verified on <http://info.fsc.org/>

Control Union Certifications declares to have inspected the unit(s), and/or products of the above mentioned certificate holder, and have found them in accordance with the standards mentioned above.

This certificate covers the unit(s), and/or product(s) as mentioned in the authenticated annex of this certificate. A full list of product groups covered by the certificate can be found on the FSC database of registered certificates (<http://info.fsc.org/>).

This certificate itself does not constitute evidence that a particular product supplied by the certificate holder is FSC-certified [or FSC Controlled Wood]. Products offered, shipped or sold by the certificate holder can only be considered covered by the scope of this certificate when the required FSC claim is clearly stated on invoices and shipping documents.

This certificate remains in force until further notice, provided that the client continues to meet the conditions as laid down in the client contract with Control Union Certifications and verified in annual inspections by Control Union Certifications.

Date of certification:
12 May 2017
Place and date of issue:
LONDON, 22 November 2017

CERTIFICATE No: C849560CU-COC-04.2017
REGISTRATION No: CU 849560



The mark of
responsible forestry

Declared by:

On behalf of the Managing Director

Miss A Priest

Certifier
Control Union Certifications
Meeuwenlaan 4-6
8011 BZ ZWOLLE
The Netherlands
<http://www.controlunion.com>
tel.: +31(0)38-4260100



Annex to
CERTIFICATION CODE: CU-COC-849560

FSC Chain of Custody (COC)

Harlow Bros Limited
Hathem Road, Long Whatton
LE12 5DE Loughborough
UNITED KINGDOM

This certificate gives the right, in accordance with the agreements in the licensee-contract, on the basis of the accreditation of CU by the Forest Stewardship Council (FSC), to use the FSC logo for the unit(s), process(es) and/or product(s) mentioned below. Use of the FSC logo on (trade) products is only allowed for products mentioned under "products" in conformity with the category.

This certificate and its copies or reproductions shall be returned to CU immediately on request.
More information about the client and/or products and/or units can be obtained at the website of CU (www.controlunion.com/certifications) or by contacting CU.

This certificate, referred to in the client contract as scope certificate, covers the following product(s), which comply(ies) with the latest version of the CU Forestry Standards:

Certified products

Product no.	Name of product	category	Processing unit(s)
P 063847	W11.14 Trusses and roofs	FSC Mix	PRC 074014, PRC 077840, PRC 077841, PRC 077842
P 063841	W11.8 Mouldings	FSC Mix	PRC 074014, PRC 077840, PRC 077841, PRC 077842
P 063772	W5 Solid wood (sawn, chipped, sliced or peeled)	FSC Mix	PRC 074014, PRC 077840, PRC 077841, PRC 077842
P 063775	W5.3 Beams	FSC Mix	PRC 077842
P 063783	W6.1 Dimensional timber and lumber, finished	FSC Mix	PRC 077842
P 063792	W8.1 Plywood	FSC Mix	PRC 074014, PRC 077840, PRC 077841, PRC 077842
P 063797	W8.2 Particleboard	FSC Mix	PRC 074014, PRC 077840, PRC 077841, PRC 077842
P 063806	W8.3 Fibreboard	FSC Mix	PRC 074014, PRC 077840, PRC 077841, PRC 077842
P 063817	W9.7 I-joist, I-beams	FSC Mix	PRC 074014, PRC 077840, PRC 077841, PRC 077842



Annex to
CERTIFICATION CODE: CU-COC-849560

FSC Chain of Custody (COC)

This certificate covers the following Processing Unit(s), which comply(ies) with the latest version of the CU Forestry Standards:

Processing units

Unit no.	Name of unit	Unit ref.	Address	Processes
PRC 074014	Harlow Bros Limited	A	Hathem Road, Long Whatton Loughborough, Leicestershire UNITED KINGDOM	Broker/trader with physical possession
PRC 077840	Harlow Group T/A Bolt Building Supplies Limited	B	Bluebridge Industrial Estate, Colchester Road Halstead, Essex UNITED KINGDOM	Retailer
PRC 077841	Harlow Bros Limited	C	Coleman Street Derby, Derbyshire UNITED KINGDOM	Retailer
PRC 077842	Harlow Group T/A Kidderminster	D	Hoobrook Industrial Estate, Worcester Road Kidderminster, UNITED KINGDOM	Broker/trader with physical possession

This certificate including the annex remains property of Control Union Certifications and can be withdrawn in case of terminations as mentioned in the licensee contract, or in case changes or deviations of the above mentioned data occur. The licensee is obliged to inform Control Union Certifications immediately of any changes in the above mentioned data. Only an original and signed certificate is valid.

Date of certification:
12 May 2017

Place and date of issue:
LONDON, 22 November 2017

Authenticated by

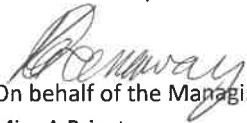
On behalf of the Managing Director
Miss A Priest
Certifier

This certificate cannot be used as guarantee certificate for delivered goods!



CERTIFICATE

CERTIFICATION CODE: CU-COC-849560

Field of attention:
FSC Chain of Custody (COC)

Issued to:
Harlow Bros Limited
Loughborough, UNITED KINGDOM
Project in: **UNITED KINGDOM**

Standard:

FSC-STD-50-001 (V1-2) Requirements for use of the FSC trademarks by Certificate Holders
FSC-STD-40-004 V2-1 FSC Standard for Chain of Custody Certification
FSC-STD-40-003 V2-1 CoC Certification of Multiple Sites

Valid until: 13 May 2022

The validity of this certificate shall be verified on <http://info.fsc.org/>

Control Union Certifications declares to have inspected the unit(s), and/or products of the above mentioned certificate holder, and have found them in accordance with the standards mentioned above.

This certificate covers the unit(s), and/or product(s) as mentioned in the authenticated annex of this certificate. A full list of product groups covered by the certificate can be found on the FSC database of registered certificates (<http://info.fsc.org/>).

This certificate itself does not constitute evidence that a particular product supplied by the certificate holder is FSC-certified [or FSC Controlled Wood]. Products offered, shipped or sold by the certificate holder can only be considered covered by the scope of this certificate when the required FSC claim is clearly stated on invoices and shipping documents.

This certificate remains in force until further notice, provided that the client continues to meet the conditions as laid down in the client contract with Control Union Certifications and verified in annual inspections by Control Union Certifications.

Date of certification:
12 May 2017
Place and date of issue:
LONDON, 22 November 2017

CERTIFICATE No: C849560CU-COC-04.2017
REGISTRATION No: CU 849560



The mark of
responsible forestry

Declared by:

On behalf of the Managing Director

Miss A Priest

Certifier
Control Union Certifications
Meeuwenlaan 4-6
8011 BZ ZWOLLE
The Netherlands
<http://www.controlunion.com>
tel.: +31(0)38-4260100



Annex to
CERTIFICATION CODE: CU-COC-849560

FSC Chain of Custody (COC)

Harlow Bros Limited
Hathem Road, Long Whatton
LE12 5DE Loughborough
UNITED KINGDOM

This certificate gives the right, in accordance with the agreements in the licensee-contract, on the basis of the accreditation of CU by the Forest Stewardship Council (FSC), to use the FSC logo for the unit(s), process(es) and/or product(s) mentioned below. Use of the FSC logo on (trade) products is only allowed for products mentioned under "products" in conformity with the category.

This certificate and its copies or reproductions shall be returned to CU immediately on request.
More information about the client and/or products and/or units can be obtained at the website of CU (www.controlunion.com/certifications) or by contacting CU.

This certificate, referred to in the client contract as scope certificate, covers the following product(s), which comply(ies) with the latest version of the CU Forestry Standards:

Certified products

Product no.	Name of product	category	Processing unit(s)
P 063847	W11.14 Trusses and roofs	FSC Mix	PRC 074014, PRC 077840, PRC 077841, PRC 077842
P 063841	W11.8 Mouldings	FSC Mix	PRC 074014, PRC 077840, PRC 077841, PRC 077842
P 063772	W5 Solid wood (sawn, chipped, sliced or peeled)	FSC Mix	PRC 074014, PRC 077840, PRC 077841, PRC 077842
P 063775	W5.3 Beams	FSC Mix	PRC 077842
P 063783	W6.1 Dimensional timber and lumber, finished	FSC Mix	PRC 077842
P 063792	W8.1 Plywood	FSC Mix	PRC 074014, PRC 077840, PRC 077841, PRC 077842
P 063797	W8.2 Particleboard	FSC Mix	PRC 074014, PRC 077840, PRC 077841, PRC 077842
P 063806	W8.3 Fibreboard	FSC Mix	PRC 074014, PRC 077840, PRC 077841, PRC 077842
P 063817	W9.7 I-joist, I-beams	FSC Mix	PRC 074014, PRC 077840, PRC 077841, PRC 077842



Annex to
CERTIFICATION CODE: CU-COC-849560

FSC Chain of Custody (COC)

This certificate covers the following Processing Unit(s), which comply(ies) with the latest version of the CU Forestry Standards:

Processing units

Unit no.	Name of unit	Unit ref.	Address	Processes
PRC 074014	Harlow Bros Limited	A	Hathem Road, Long Whatton Loughborough, Leicestershire UNITED KINGDOM	Broker/trader with physical possession
PRC 077840	Harlow Group T/A Bolt Building Supplies Limited	B	Bluebridge Industrial Estate, Colchester Road Halstead, Essex UNITED KINGDOM	Retailer
PRC 077841	Harlow Bros Limited	C	Coleman Street Derby, Derbyshire UNITED KINGDOM	Retailer
PRC 077842	Harlow Group T/A Kidderminster	D	Hoobrook Industrial Estate, Worcester Road Kidderminster, UNITED KINGDOM	Broker/trader with physical possession

This certificate including the annex remains property of Control Union Certifications and can be withdrawn in case of terminations as mentioned in the licensee contract, or in case changes or deviations of the above mentioned data occur. The licensee is obliged to inform Control Union Certifications immediately of any changes in the above mentioned data. Only an original and signed certificate is valid.

Date of certification:
12 May 2017

Place and date of issue:
LONDON, 22 November 2017

Authenticated by

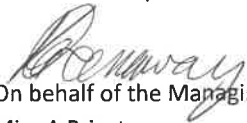
On behalf of the Managing Director
Miss A Priest
Certifier

This certificate cannot be used as guarantee certificate for delivered goods!



The mark of
responsible forestry

CERTIFICATE OF REGISTRATION

This is to certify that

Charles Ransford & Son Ltd

Station Street
Bishop's Castle
Shropshire
SY9 5AQ

has been audited and found to meet the requirements of standard(s)
FSC-STD-40-004 (Version 3.0) EN, FSC-STD-40-005 (Version 3.1) EN and
FSC-STD-50-001 (Version 2.0) EN for FSC® Chain of Custody Certification

Scope of certification

The purchasing, processing, sales and distribution of softwood timber
products, wood chips and sawdust incorporating a minimum 70% FSC
certified virgin wood

Products:

W3 Wood in chips or particles
W5 Solid wood

Certificate number: TT-COC-001931

Issue number: 2019-01

Certificate start date: 7 April 2019

Certificate expiry date: 6 April 2024

Date of initial certification: 7 April 2004

Karen Prendergast
Divisional Director - Certification
BM TRADA

Issuing Office: Warringtonfire Testing and Certification Limited t/a bmtrada Chiltern House, Stocking Lane, High Wycombe,
Buckinghamshire, HP14 4ND, UK
Registered Office: 10 Lower Grosvenor Place, London, United Kingdom, SW1W 0EN Reg.No. 11371436

This certificate remains the property of BM TRADA. This certificate and all copies or reproductions of the certificate shall be returned to BM TRADA or destroyed if requested. The validity of this certificate and the list of products covered by this certificate should be verified at www.fsc-info.org Forest Stewardship Council®

This certificate itself does not constitute evidence that a particular product supplied by the certificate holder is FSC certified (or FSC Controlled Wood). Products offered, shipped or sold by the certificate holder can only be considered to be covered by the scope of this certificate when the required FSC claim is stated on invoices and shipping documents.



The mark of
responsible forestry

CERTIFICATE OF REGISTRATION

This is to certify that

Charles Ransford & Son Ltd

Station Street
Bishop's Castle
Shropshire
SY9 5AQ

has been audited and found to meet the requirements of standard(s)
FSC-STD-40-004 (Version 3.0) EN, FSC-STD-40-005 (Version 3.1) EN and
FSC-STD-50-001 (Version 2.0) EN for FSC® Chain of Custody Certification

Scope of certification

The purchasing, processing, sales and distribution of softwood timber
products, wood chips and sawdust incorporating a minimum 70% FSC
certified virgin wood

Products:

W3 Wood in chips or particles
W5 Solid wood

Certificate number: TT-COC-001931

Issue number: 2019-01

Certificate start date: 7 April 2019

Certificate expiry date: 6 April 2024

Date of initial certification: 7 April 2004

Karen Prendergast
Divisional Director - Certification
BM TRADA

Issuing Office: Warringtonfire Testing and Certification Limited t/a bmtrada Chiltern House, Stocking Lane, High Wycombe,
Buckinghamshire, HP14 4ND, UK
Registered Office: 10 Lower Grosvenor Place, London, United Kingdom, SW1W 0EN Reg.No. 11371436

This certificate remains the property of BM TRADA. This certificate and all copies or reproductions of the certificate shall be returned to BM TRADA or destroyed if requested. The validity of this certificate and the list of products covered by this certificate should be verified at www.fsc-info.org Forest Stewardship Council®

This certificate itself does not constitute evidence that a particular product supplied by the certificate holder is FSC certified (or FSC Controlled Wood). Products offered, shipped or sold by the certificate holder can only be considered to be covered by the scope of this certificate when the required FSC claim is stated on invoices and shipping documents.

We certify that the system covered by this certificate has been commissioned satisfactorily.			
Site Name	CALDER PARK	Completion	W. SPINDLEY
Site Reference	G42793	Engineers Installing	W. SPINDLEY
Installation Commenced	13 / 09 / 2022	Commissioning	W. SPINDLEY
Equipment Fitted	3x ELECTRIC BARRIER 3x SAFETY LASER 3x PUSH BUTTONS		
Handover Date	13.09.22		

Part 2. Existing Installation Items not covered under warranty/ This certificate:

Part 3. Certificate Signing off Section

Installers Name	W. SPINDLEY	Signature	
On Behalf of	GATEWAY AUTOMATION	Date of Signing	13.09.22
Address	UNIT 8, WAINER CLOSE LONDON LN6 3L1	Position	ENGINEER
Client Name	ALA LAMBS	Signature	
On Behalf of	WINVIC CONSTRUCTION	Date of Signing	
Site Address	CALDER PARK WAKEFIELD WK4 3FL	Position	

Cleaning and Maintenance Regimes



winvic

winvic.co.uk

Cleaning and Maintenance Regimes

This Maintenance and Cleaning Maintenance is to be followed for maintenance schedule for P21-024 Calder Park, Wakefield is to be followed from PC date year on year to ensure all plant and equipment is kept within warranty.

Please keep a log of these inspections so that records can be checked should an issue arise.

Code; ü Blue – Recommended ü Red – To Maintain Warranty

Item	Daily	Weekly	Monthly	3 Months	6 Months	9 Months	Annually	5 Yearly	Certificates	Regime
V-mex Fencing & Gates							ü		N/A	Annually - Best practise to visually check for cracks, damage and overall maintenance Clean using lukewarm water when necessary.
Armco barrier							ü		N/A	Annually - Best practise to visually check for cracks, damage and overall maintenance Clean using lukewarm water when necessary.
Timber Binstore							ü		N/A	Annually - Best practise to visually check for cracks, damage and overall maintenance Clean using lukewarm water when necessary.
Cycle Shelters							ü		N/A	Annually - Best practise to visually check for cracks, damage and overall maintenance Clean using lukewarm water when necessary.
Bollards							ü		N/A	Annually - Best practise to visually check for cracks, damage and overall maintenance Clean using lukewarm water when necessary.
Automated Barriers & Gates							ü		Commissioning	Annually - Best practise to visually check for cracks, damage and overall maintenance Clean using lukewarm water when necessary.

A. & A. LAMB LIMITED

FENCING CONTRACTORS

Walton New Road ° Upper Bruntingthorpe ° Nr Lutterworth ° Leics. LE17 5RD

Telephone: 0116 247 8396 ° Fax No: 0116 247 8876

All fencing should be periodically checked and any damaged components repaired or replaced.
If cleaning is required then this should be carried out using warm soapy water and a cloth.

1.8.1 Planned Maintenance Strategy

Item	Periodically	Weekly	Monthly	3 Months	6 Months	9 Months	Annually	5 Yearly	File – Section (for further information)
Fencing, Barriers, Bollards & Shelters	□								Winvic to fill in Volume 2 Binder 3 Section 2.11
The Building Manager or other delegated person needs to be aware of the Control of Substances Hazardous to Health – COSHH and also the CDM Regulations 2015 and the CDM Amendments 2000.									

1.8.2 Planned Cleaning Strategy

Item	Periodically	Weekly	Monthly	3 Months	6 Months	9 Months	Annually	5 Yearly	File – Section (for further information)
Fencing, Barriers, Bollards & Shelters	□								Winvic to fill in Volume 2 Binder 3 Section 2.11
The Building Manager or other delegated person needs to be aware of the Control of Substances Hazardous to Health – COSHH and also the CDM Regulations 2015 and the CDM Amendments 2000.									

Yours faithfully

Aby Richards

A. & A. Lamb Limited

Data Sheets



winvic

winvic.co.uk

GA3250 Automatic Barrier



SPECIFICATION

MAXIMUM SPAN:

7.0m Plain Pole, 6.0m with bottom skirt,
5.0m with a top and bottom skirt.

BOOM DIAMETER:

76mm

DIMENSIONS:

405mm x 420mm x 1140mm

OPENING/CLOSING TIMES:

1.2 to 6 seconds (adjustable)

DRIVE UNIT:

Inverter driven 3 phase motor and wormed
Gearbox

POWER SUPPLY:

230VAC, 50Hz 6AMPS

CYCLES:

100% Continuous Duty rating

FINISH:

Polyester Powder coated



PLC CONTROL

GA3250 Barriers are Fitted with a Schneider PLC unit with a Graphic Display to simplify Commissioning and Maintenance. There are Many adjustable Parameters including Speed adjustment, with A slow down feature, And a standard time Clock function.



SKIRT

A lower skirt or hi-bar upper and lower Version can be fitted to the barrier at Additional cost, and a high visibility STOP or NO ENTRY signs and LED Boom lights may be specified to the Boom.



FINISH

Barriers are powder coated in Red and White or Black and yellow as standard, However , other standard RAL colours May be specified at no additional cost. Booms are vinyl striped in red and white With a limited choice of other colours

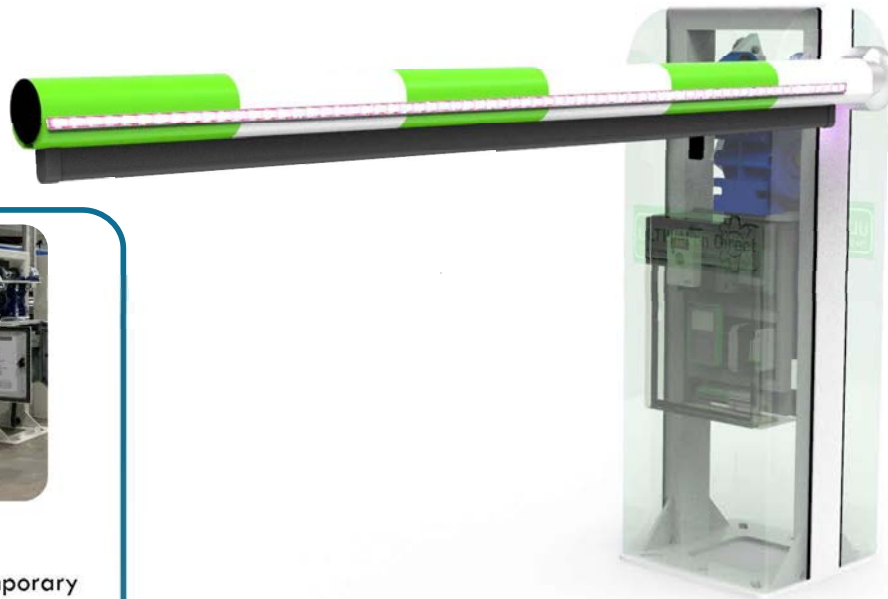

LOGO

To Enhance your Site entrance we Are able to Produce LED Backlit logos Into the barrier Covers. These Are designed on CAD and cut into The steel sheet With our water Jet cutter and Back with colour Changing LEDs.

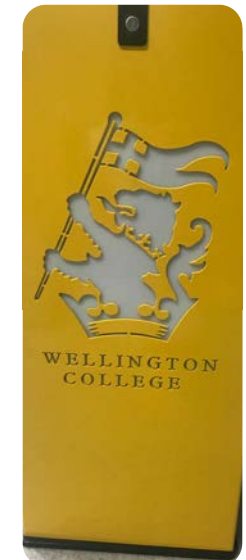

BARRIER DESIGN

The cabinet had a clean contemporary Appearance with fully removable Clamshell Covers to both sides to allow complete access to all internal components.

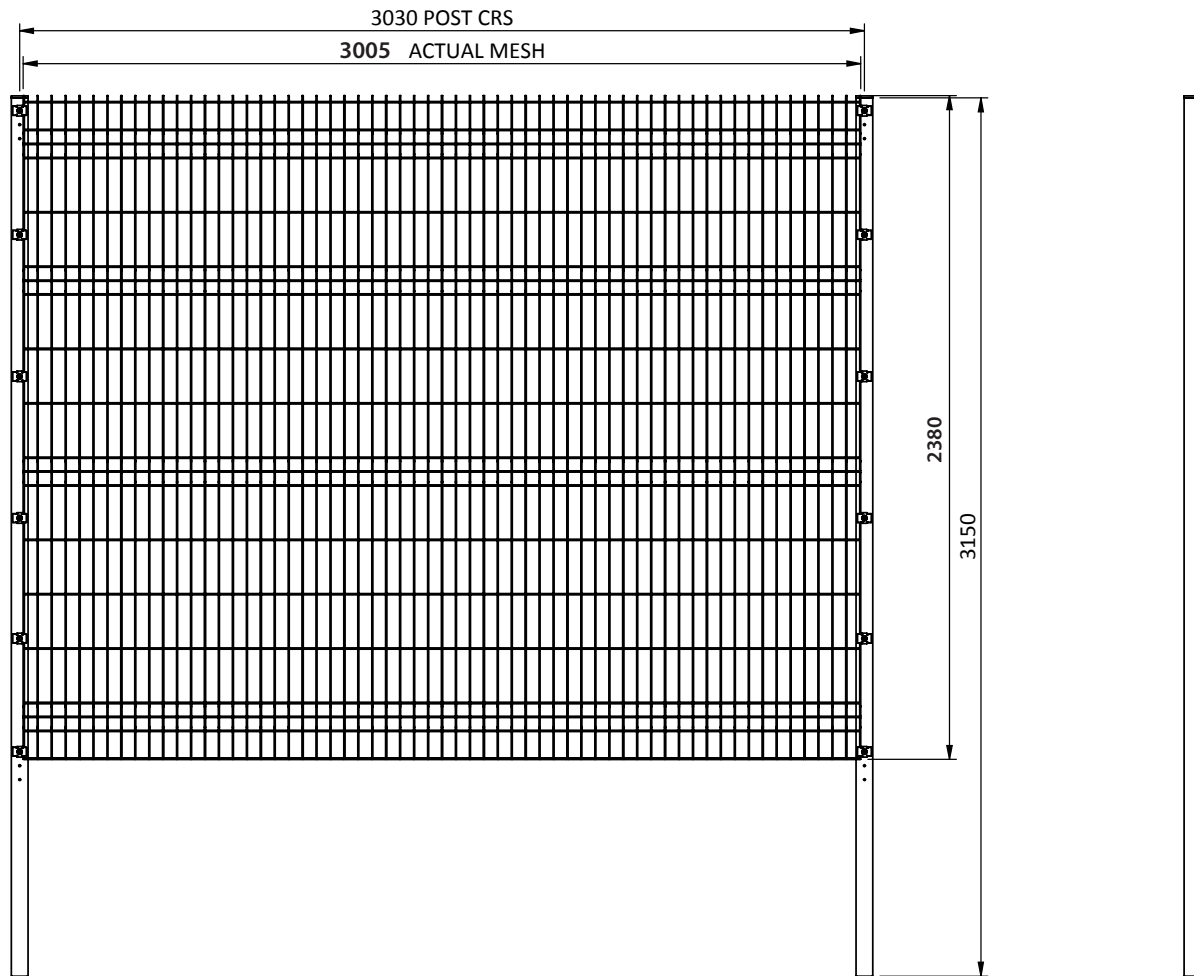

Vmex® V3 Specification

PANEL

Heights	2400mm
Wire Diameter	4mm verticals & 5mm horizontals (nominal)
Aperture Size	195 x 50mm
Panel Width	3005mm

POSTS

Post Size	60 x 60 SHS
Post Centres	3030mm

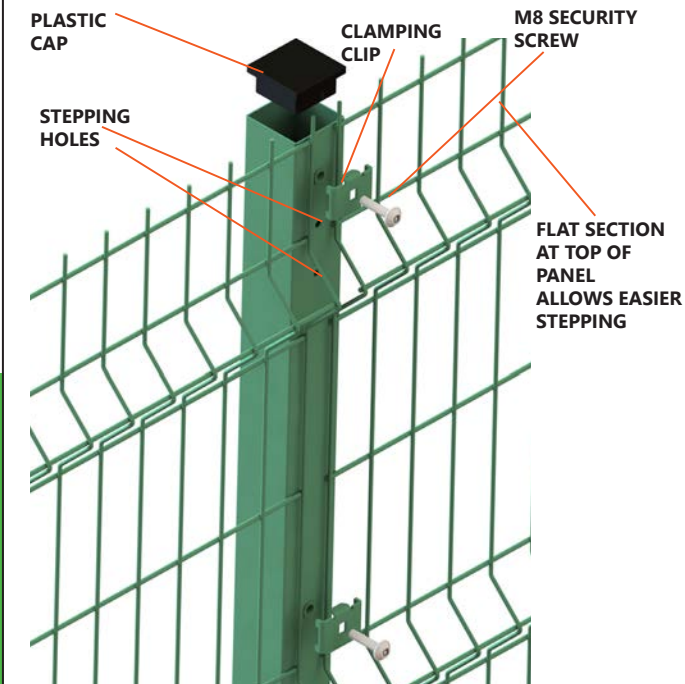
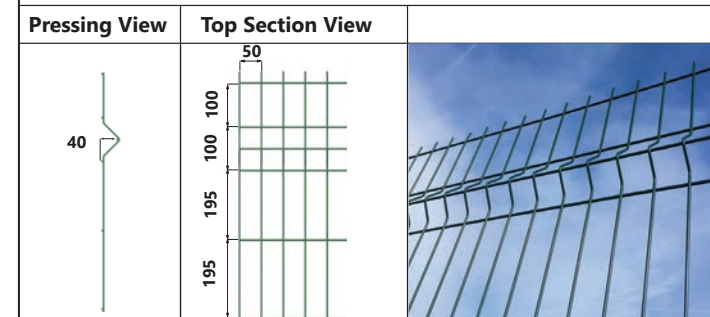

Features:

- ▶ Compliant to BS 1722 Pt. 14
- ▶ Available from stock
- ▶ Base-plated post option from stock
- ▶ M8 Security fixings
- ▶ Top flat section of panel allows easier stepping of mesh
- ▶ Standard colours GREEN RAL 6005 + BLACK RAL 9005 available from stock
- ▶ Other colours available to order

Suitable for:

- ▶ Schools, Colleges & Universities
- ▶ Commercial Premises
- ▶ Industrial Units
- ▶ Solar Farms

A. & A. LAMB LIMITED

Walton New Road
Upper Bruntingthorpe
Nr Lutterworth
Leics, LE17 5RD

TEL: 0116 247 8396
FAX: 0116 247 8876

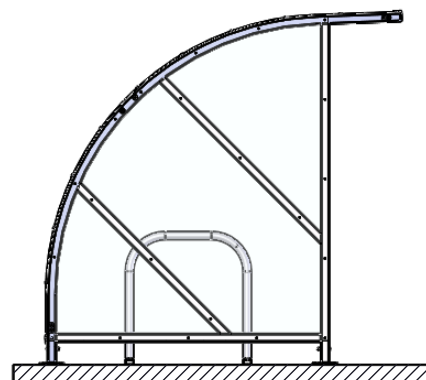
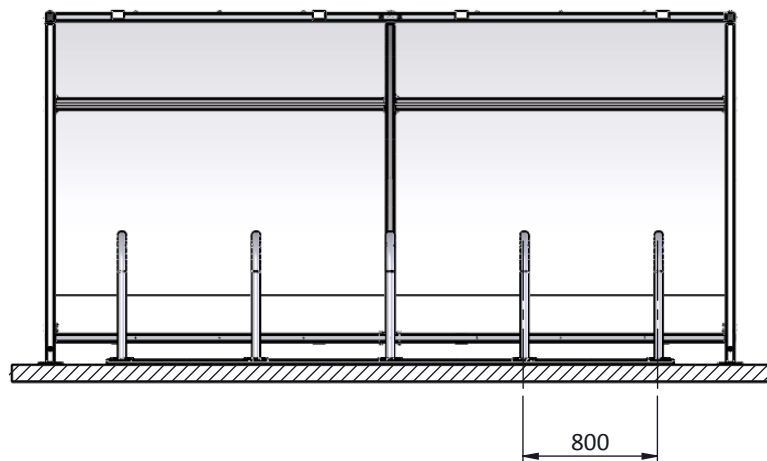

DETAIL A
SCALE 1 : 10

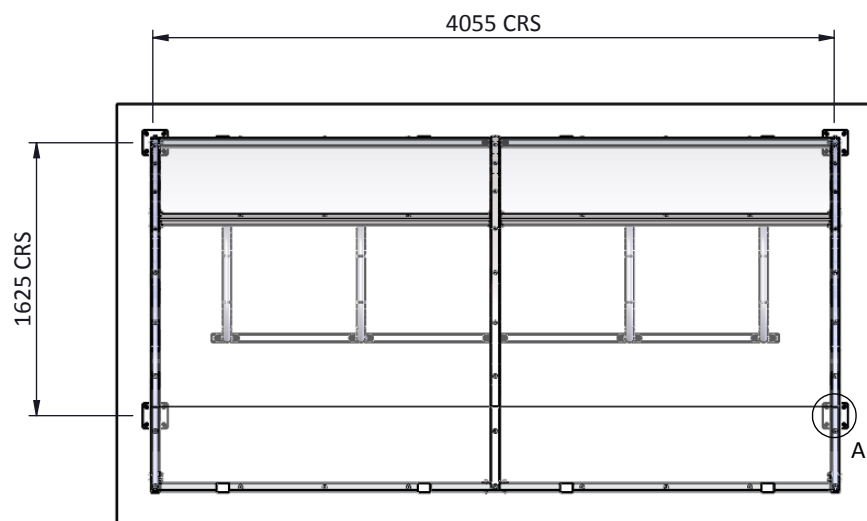
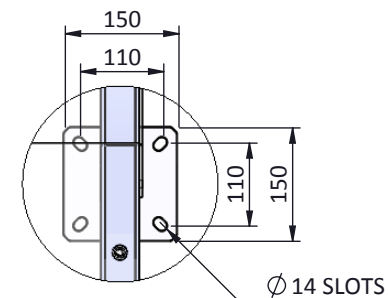

SPECIFICATION
50 X 50 SHS FRAME
HEIGHT ADJUSTABLE FEET
4mm UV PETG CLADDING
5-HOOP CYCLE RACK 800mm CRS

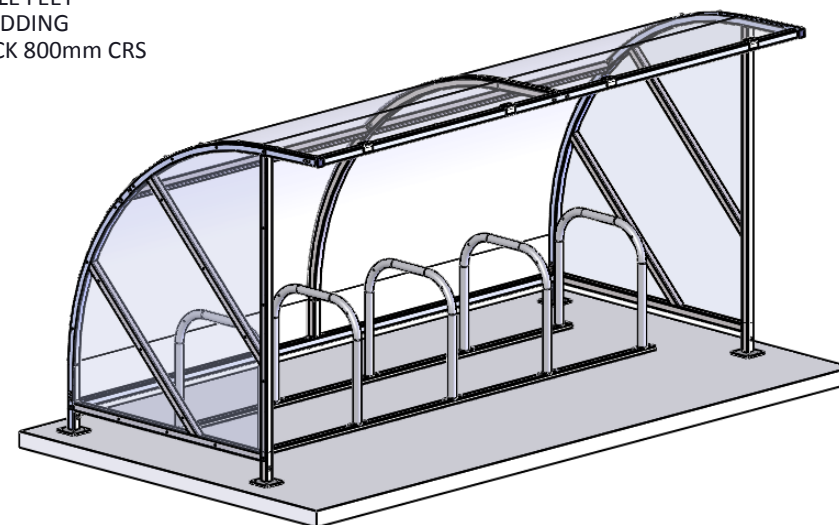

A. & A. LAMB LIMITED

FENCING CONTRACTORS

WALTON NEW ROAD, UPPER BRUNTINGTHORPE,
NR. LUTTERWORTH, LEICS. LE17 5RD
TELEPHONE: (0116) 247 8396 Fax: (0116) 247 8876

TITLE

10 CAPACITY CYCLE SHELTER

CLIENT

SCALE NTS

A4

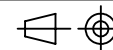

ORDER No.

DRAWN

DATE

PED

22/01/2014

DRG No. 017289-02

REV. .

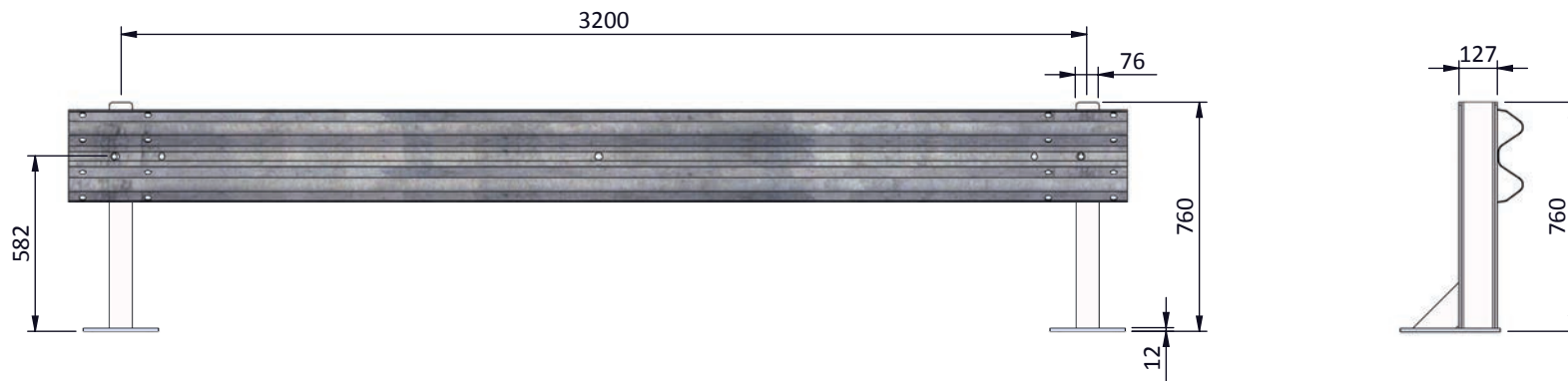

DETAIL A
SCALE 1 : 10

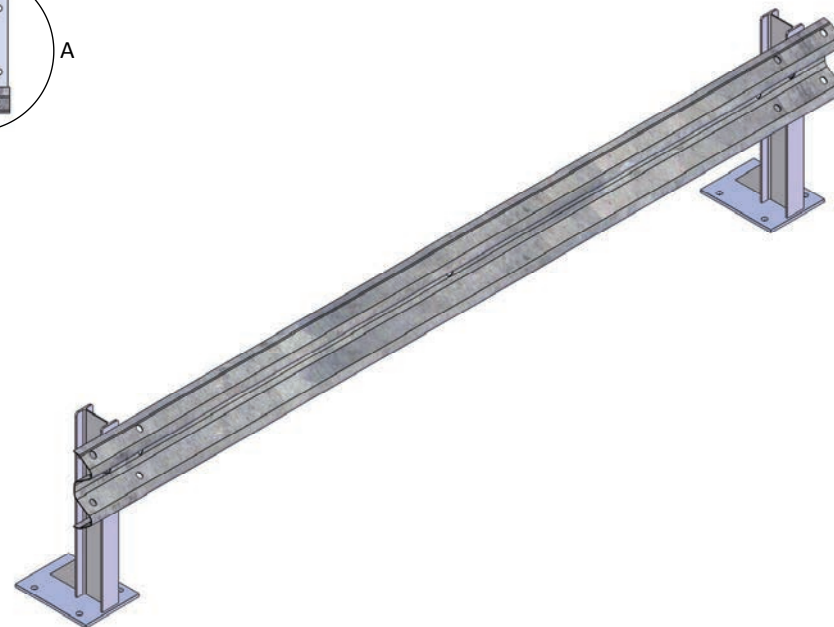
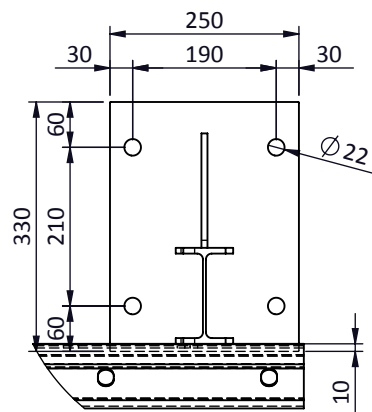

A. & A. LAMB LIMITED

FENCING CONTRACTORS

WALTON NEW ROAD, UPPER BRUNTINGTHORPE,
NR. LUTTERWORTH, LEICS. LE17 5RD
TELEPHONE: (0116) 247 8396 Fax: (0116) 247 8876

TITLE

ARMCO BARRIER

CLIENT

SCALE NTS

A4

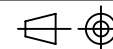

ORDER No.

DRAWN

DATE

DRG No. 016961-24

PED

19/11/2014

REV. .